



Room Type	Size (Gross Floor Area)	Monthly Rate
Studios	547 sf – 699 sf	HK\$54,600 – HK\$236,800
1-Bedroom Suites	903 sf – 1,167 sf	
2-Bedroom Suites	1,433 sf – 1,490 sf	
3-Bedroom Suites	1,867 sf	

Room rate is inclusive of management fee, government rates, electricity, water supply, air-conditioning, local calls, fax line, kitchenette, cutlery, housekeeping and linen. It will be calculated based on the actual number of calendar days of the relevant month included in the period of stay.

Attentive Services

Daily Housekeeping (except Sundays & Public Holidays)
Bed linen changed 3 times per week
24-hour Concierge and In-room Dining Service

In-room Provisions

46" IPTV
Blu-ray player
Bose Home Entertainment System #
DAB radio with alarm clock
Welcome package and bathroom amenities upon arrival

Fully Equipped Kitchenette

Refrigerator
Washer/ Dryer
Microwave with oven (2-bed & 3-bed)
Microwave with grill (studio & 1-bed)
Electric hob, Nespresso coffee machine, Blender, Kettle, Toaster
Range of crockery, glassware, tableware and utensils
Dishwasher #

Dedicated Facilities

Rooftop heated pool and Jacuzzi
Gymnasium and Sky Lounge on 59/F
Reading room with internet access
Children's playroom
Laundromat

Except Studios

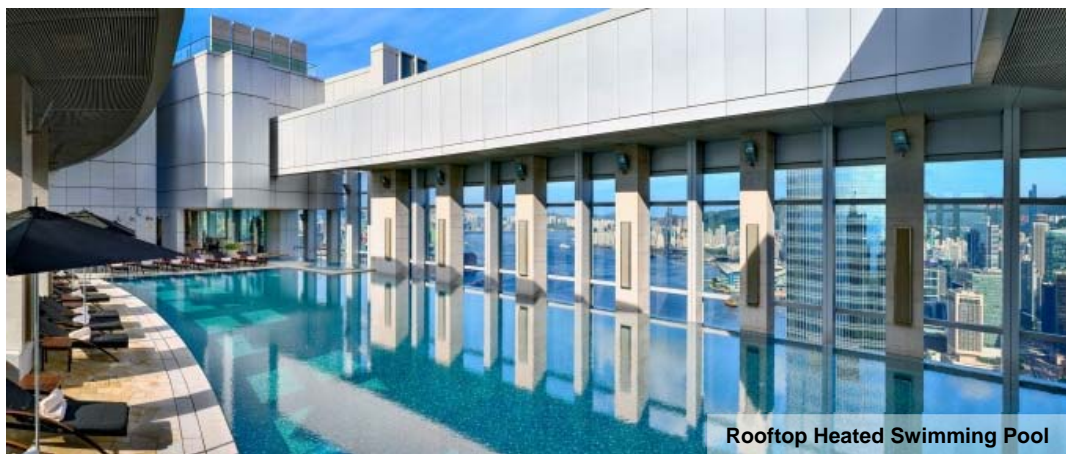

Contract Term

1 to 12 months

Deposit

Company Contract (HK Registered Company Only)

Below 7 months : 1 month's room rate
From 7 to 12 months : 2 months' room rate

Personal Contract

2 months or below : 1 month's room rate
Above 2 months to 12 months : 2 months' room rate

Payment Method

Bank Transfer / Cheque/ e-Cheque/ Cashier Order/ Direct Debit

Additional Services

Wireless Broadband service HK\$600 per month
Personal Storage Space at HK\$2,200 per month (1.2m(H) x 1.2m (W) x 0.7m (D))
Car Parking Space at HK\$6,200 per month
Free Shuttle Service from / to Hong Kong Station (Airport Express) and Four Season Place
Access to Hotel Swimming Pool, Fitness Centre & Spa Vitality Lounge:
- Monthly pass at HK\$7,500 per person & Day pass at HK\$750 per person

Fully Equipped Kitchenette

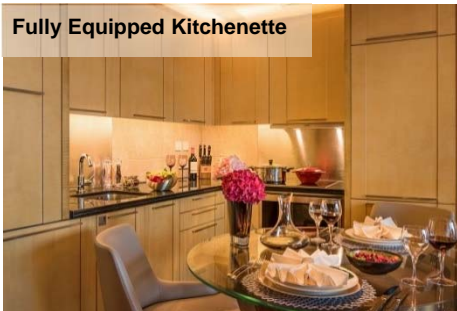

1-bed by Yabu Pushelberg design



Bathroom by Bilkey Llinas design





Transport Convergence

Interchange for the Airport Express and MTR
Cross-harbor Star Ferry and Ferries to outlying islands
Public bus and minibus terminus
Covered walkway connecting to Central Business District

Enquiry

(852) 3196 8228

(852) 9728 1886  

enquiries@fsphk.com

www.fsphk.com



The information contained herein is for reference only. Some of the photos may have been enhanced by computer graphics. It is subject to change without prior notice and does not form part of any offer or contract.